

# Switching characters

## EVEMugCheck - Flow 3: Switching between characters

Author: Dean Ezra  
Copyright of Dean Ezra 2014  
All rights reserved, not to be redistributed with Authors consent

This flow shows how the end user can switch to a different Character that is stored on the current EVE Account.  
Once switched, the end user is able to browse the Skills/Mails/Kills & Losses for the newly selected character

Prerequisites:  
- EVE account has been loaded (e.g. flow 1 run)

Expected results:  
- The data shown is of the newly selected character.  
- The end user can move up and down the list view browsing each skill, mail or kill & loss

User presses on the 'Select char' button in action bar.  
NOTE That Bob Adama character is shown at start

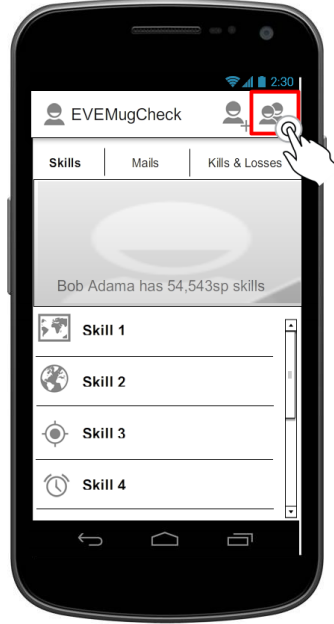

User presses on another character

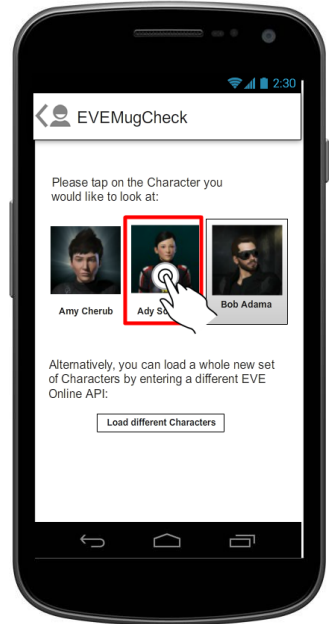

The newly selected characters information is loaded and displayed.  
NOTE That new chars name of Ady Scarlet is shown



Switch char

Taps on char